



SOVVENT ME SOVVIENT













Aula Principis Caroli

**PALATIVM PRINCIPIS
in Vrbe Brugenſi**

- 1. *Strada Regia*
- 2. *De Sclapen*
- 3. *De Capelle*
- 4. *Abbatia Sancti*
- 5. *Conventus Sancti*
- 6. *Abbatia Sancti*
- 7. *Abbatia Sancti*
- 8. *Abbatia Sancti*
- 9. *Abbatia Sancti*
- 10. *Abbatia Sancti*
- 11. *Abbatia Sancti*
- 12. *Abbatia Sancti*





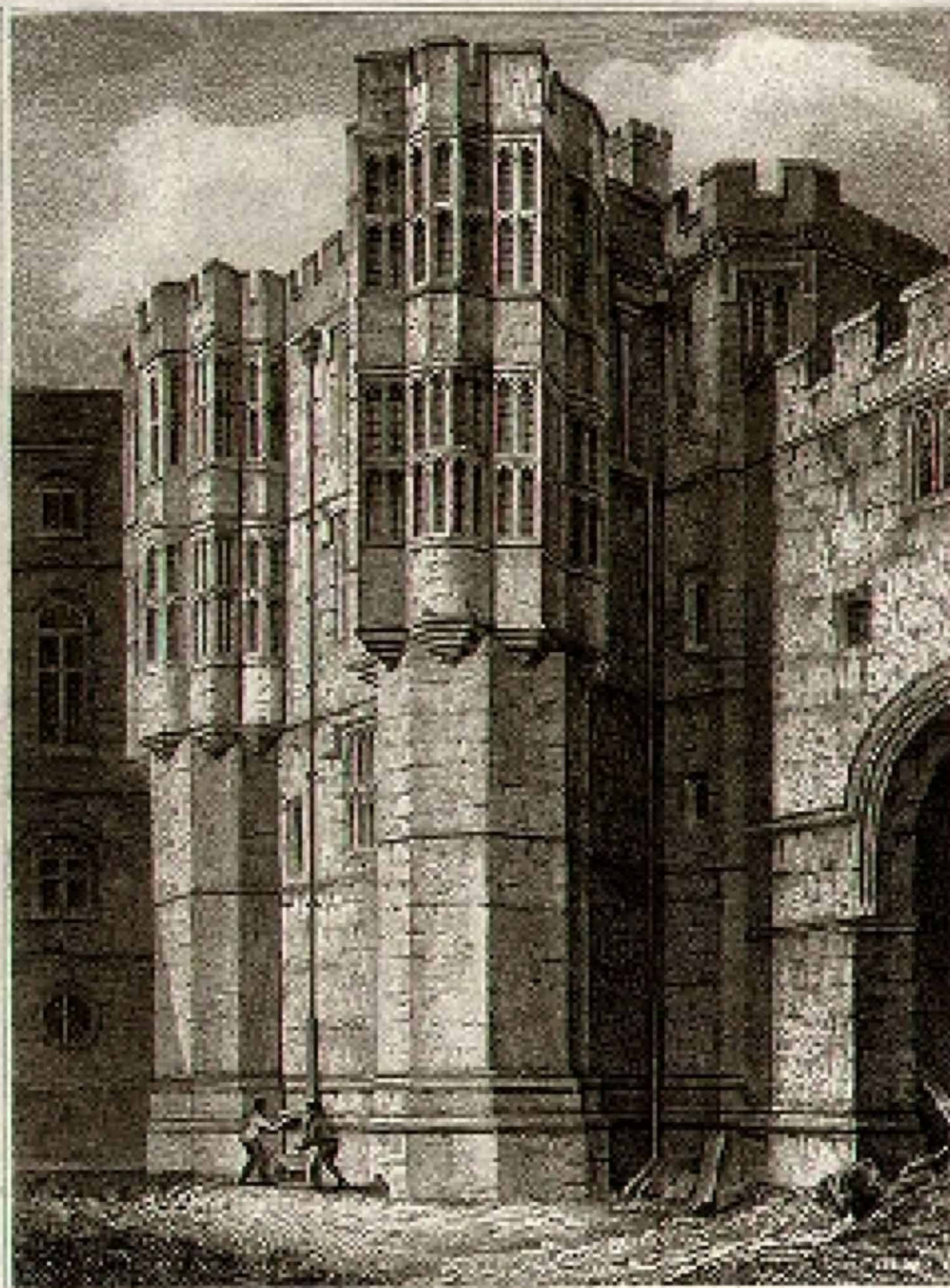

Engraved from a drawing by C. Kneller for the Judgment of Lord Nelson.

WINDSOR CASTLE

See Plate 1.

View of a part built by Henry the 2d.





CARDINAL

WOLSEY



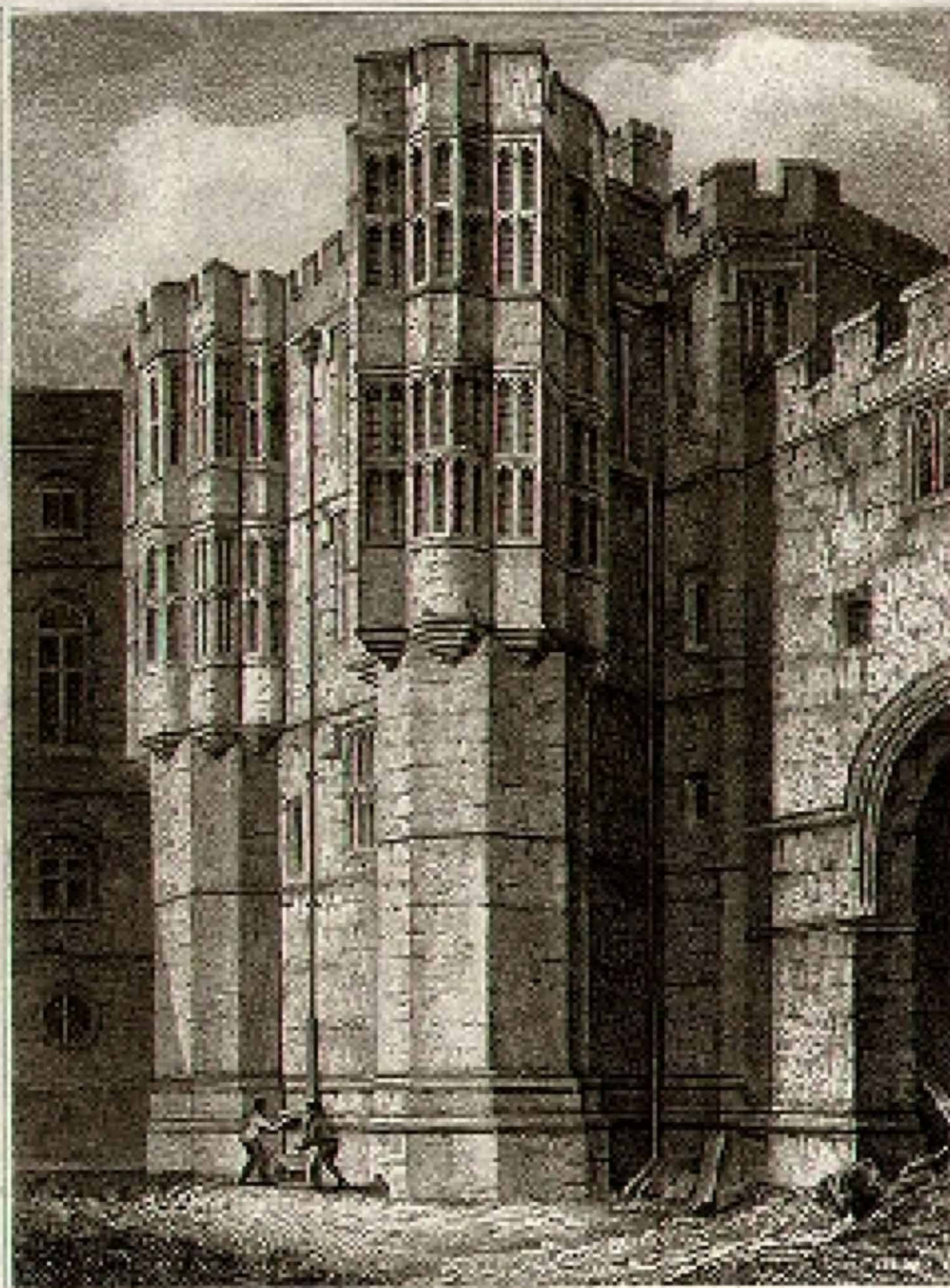

Engraved from a drawing by C. Smith for the Antiquarian Repository of Great Britain.

WINDSOR CASTLE

See Plate 1.

View of a part built by Henry the 2d.

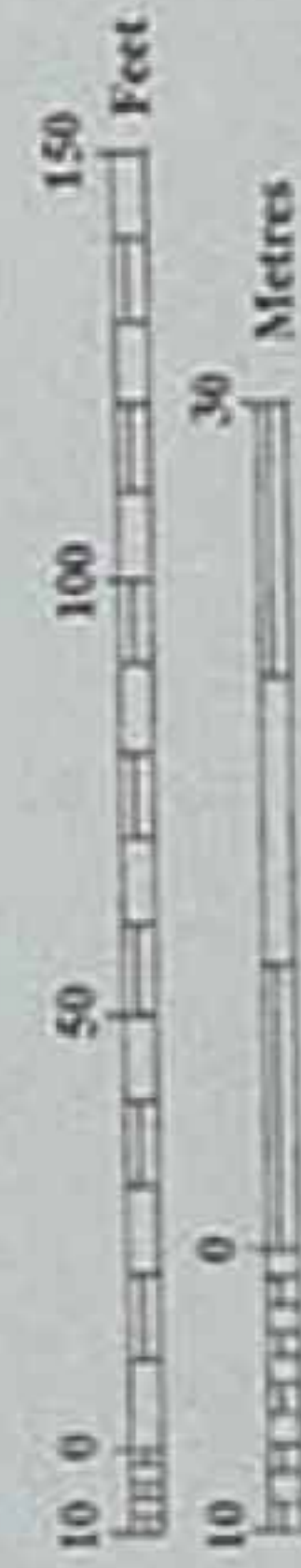
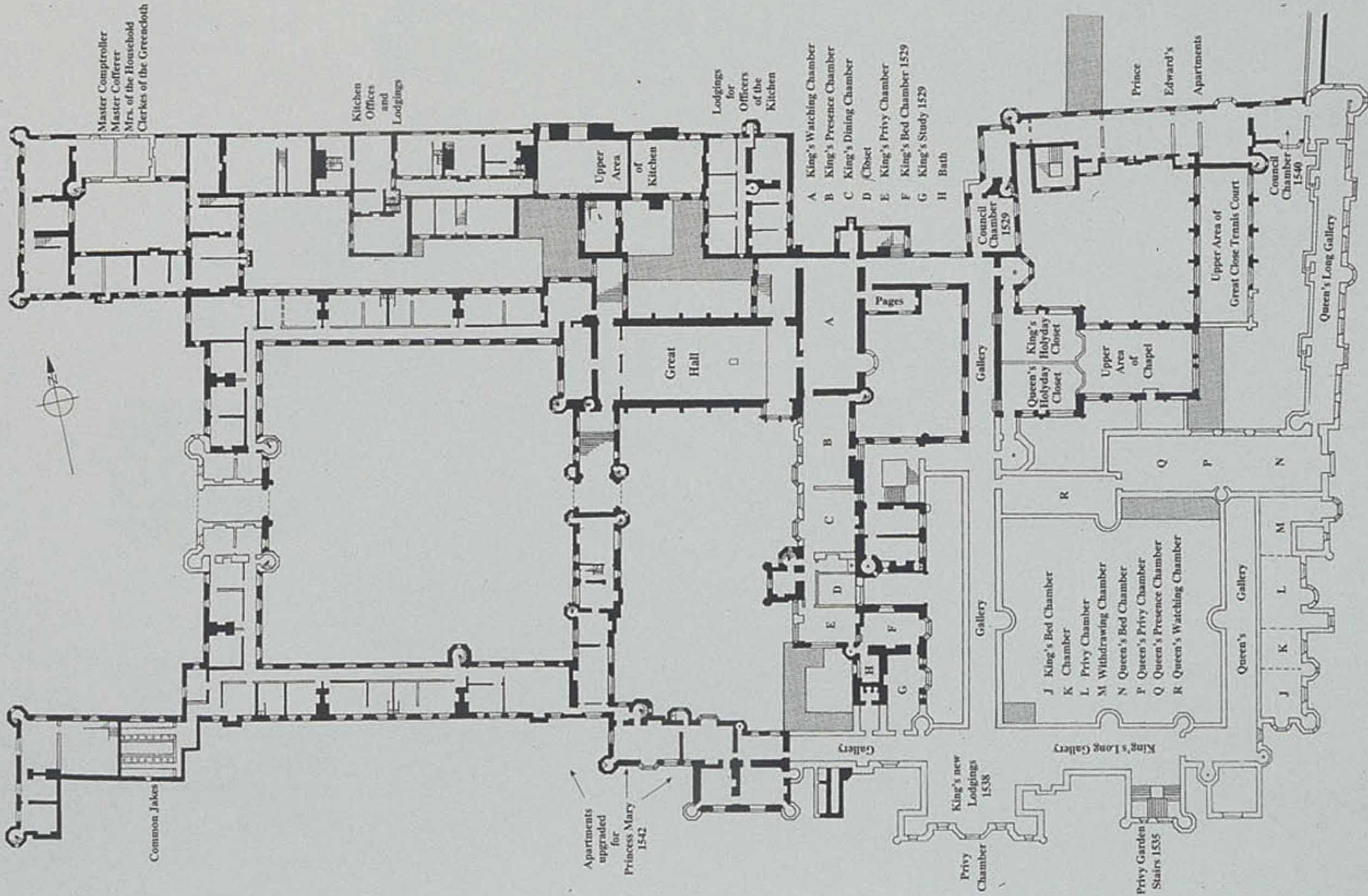

- Confirmed feature in-situ or in excavation.
- Inferred from documentary evidence.
- Conjectural.

FIRST FLOOR. c.1547

78 Reconstructed first-floor plan of Hampton Court in c.1547. Drawing Daphne Ford.



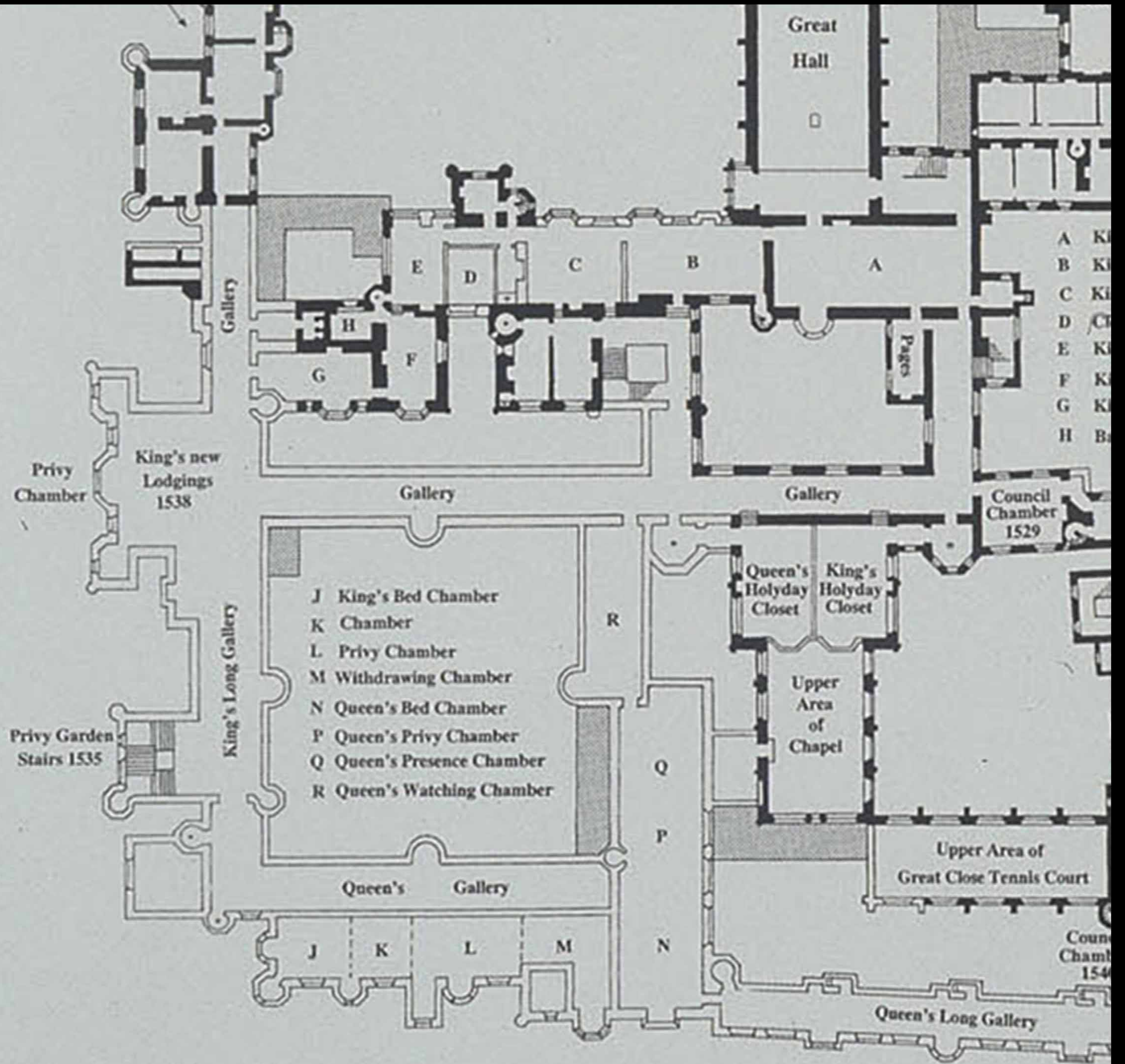



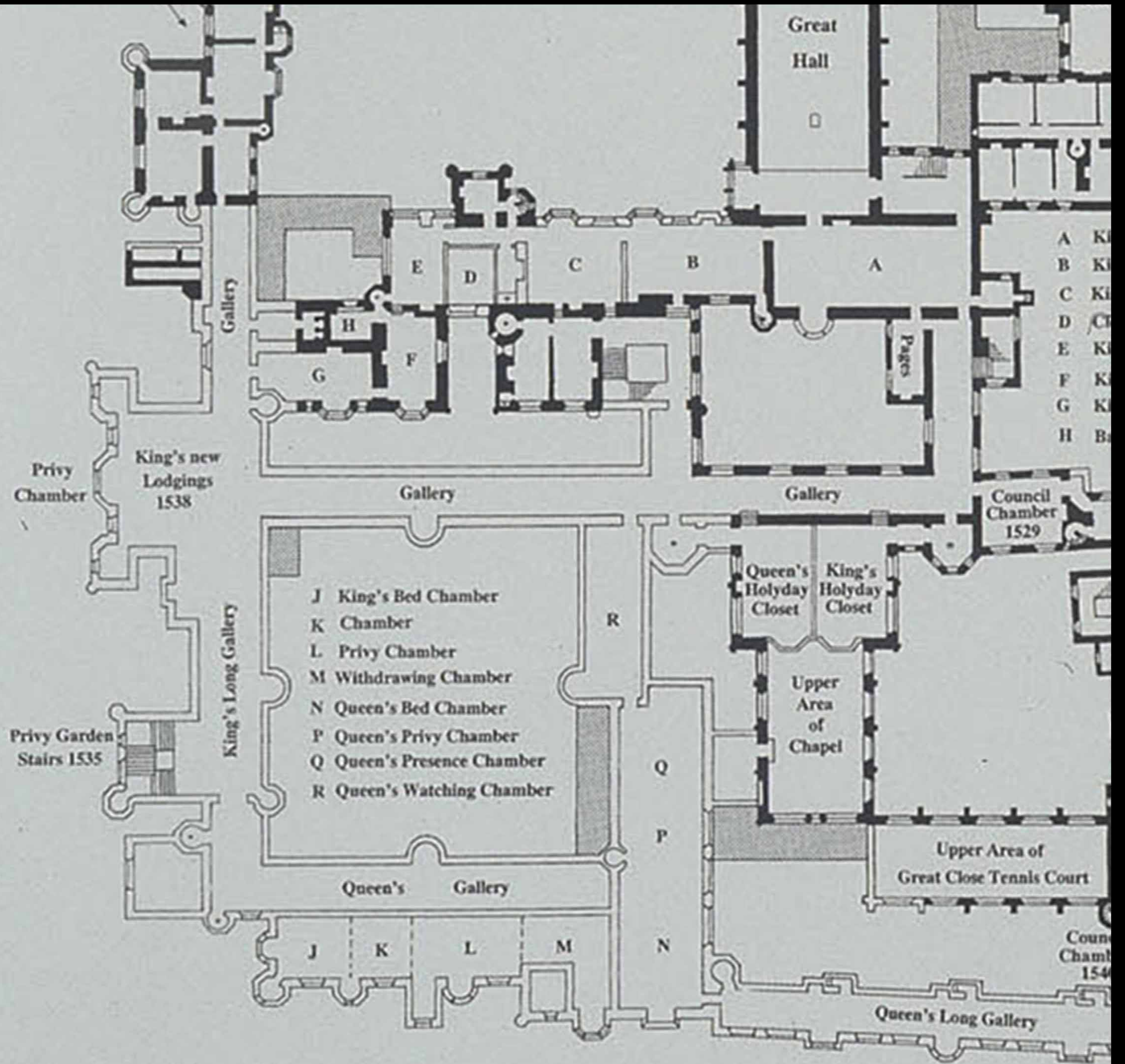



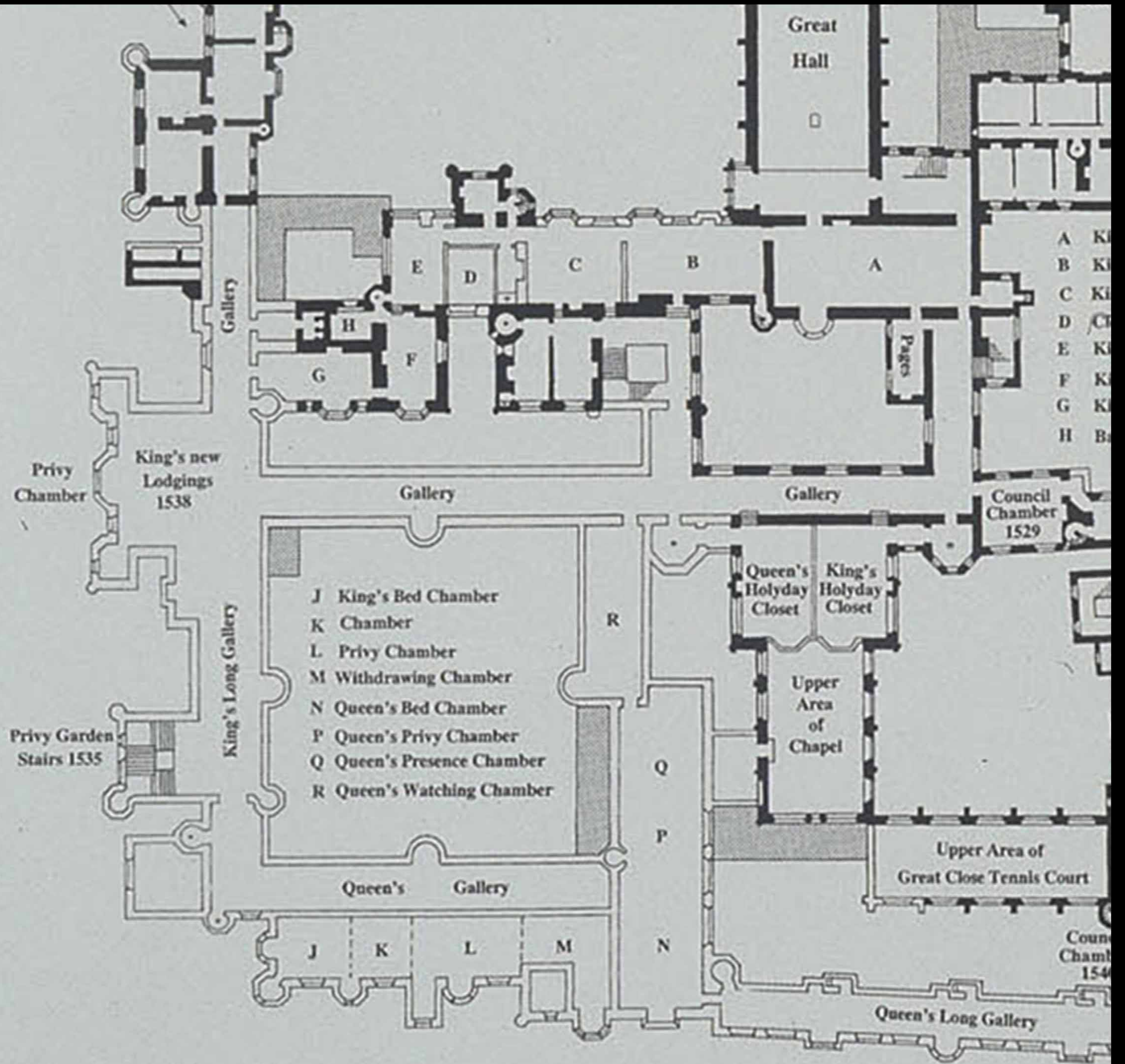





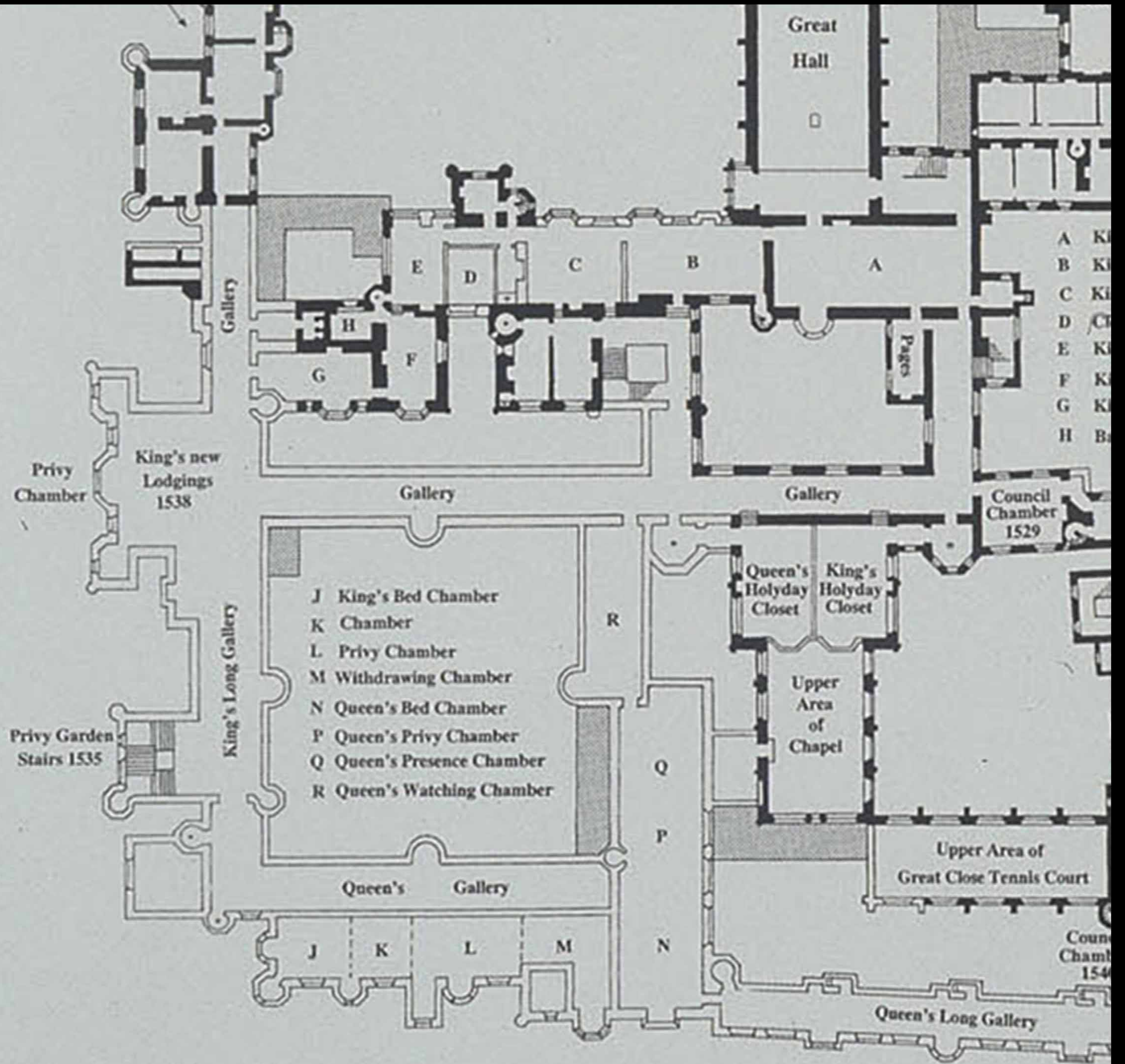

A K
 B K
 C K
 D C
 E K
 F K
 G K
 H B

- J King's Bed Chamber
- K Chamber
- L Privy Chamber
- M Withdrawing Chamber
- N Queen's Bed Chamber
- P Queen's Privy Chamber
- Q Queen's Presence Chamber
- R Queen's Watching Chamber

Coun
 Cham
 154





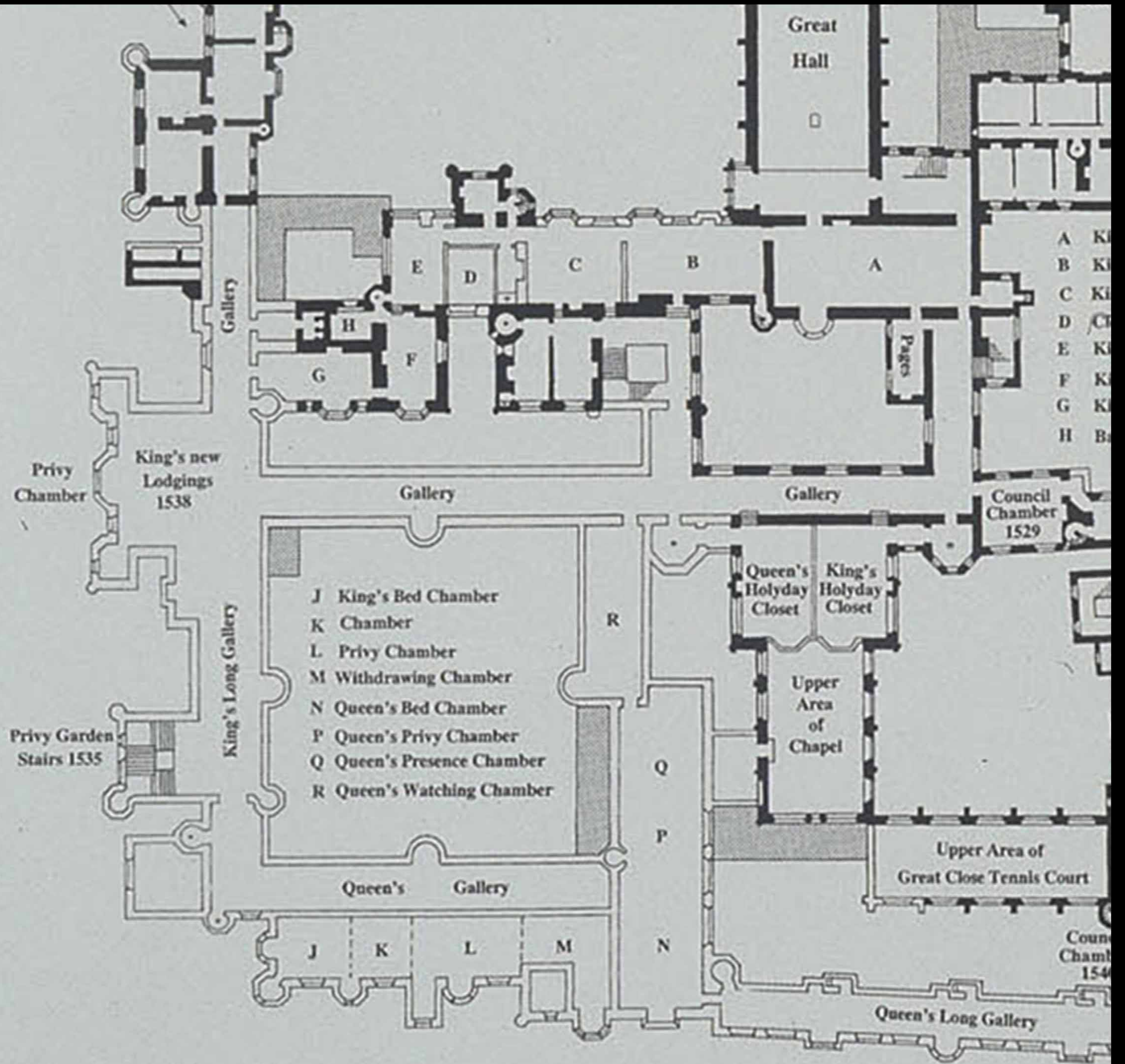

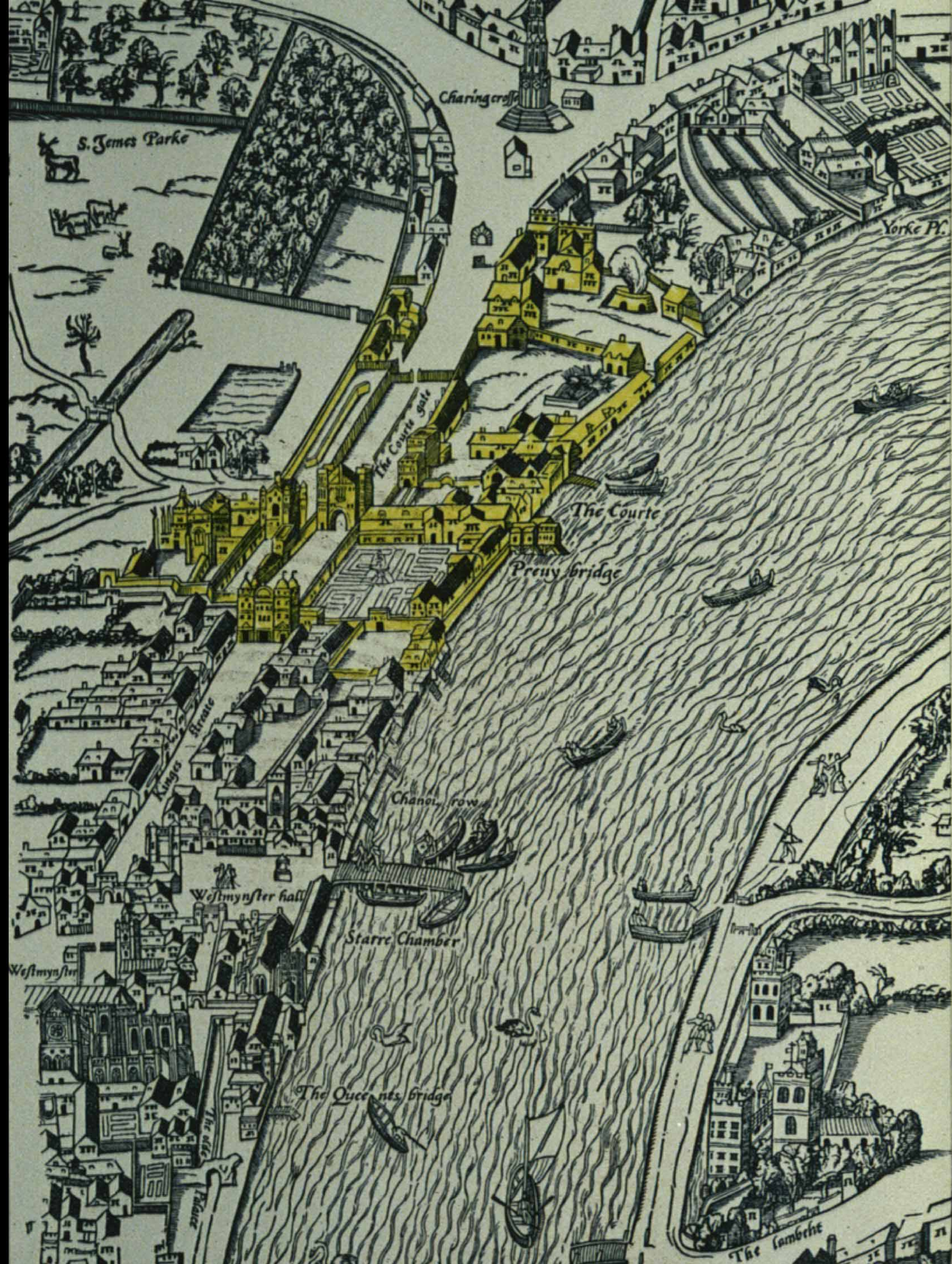



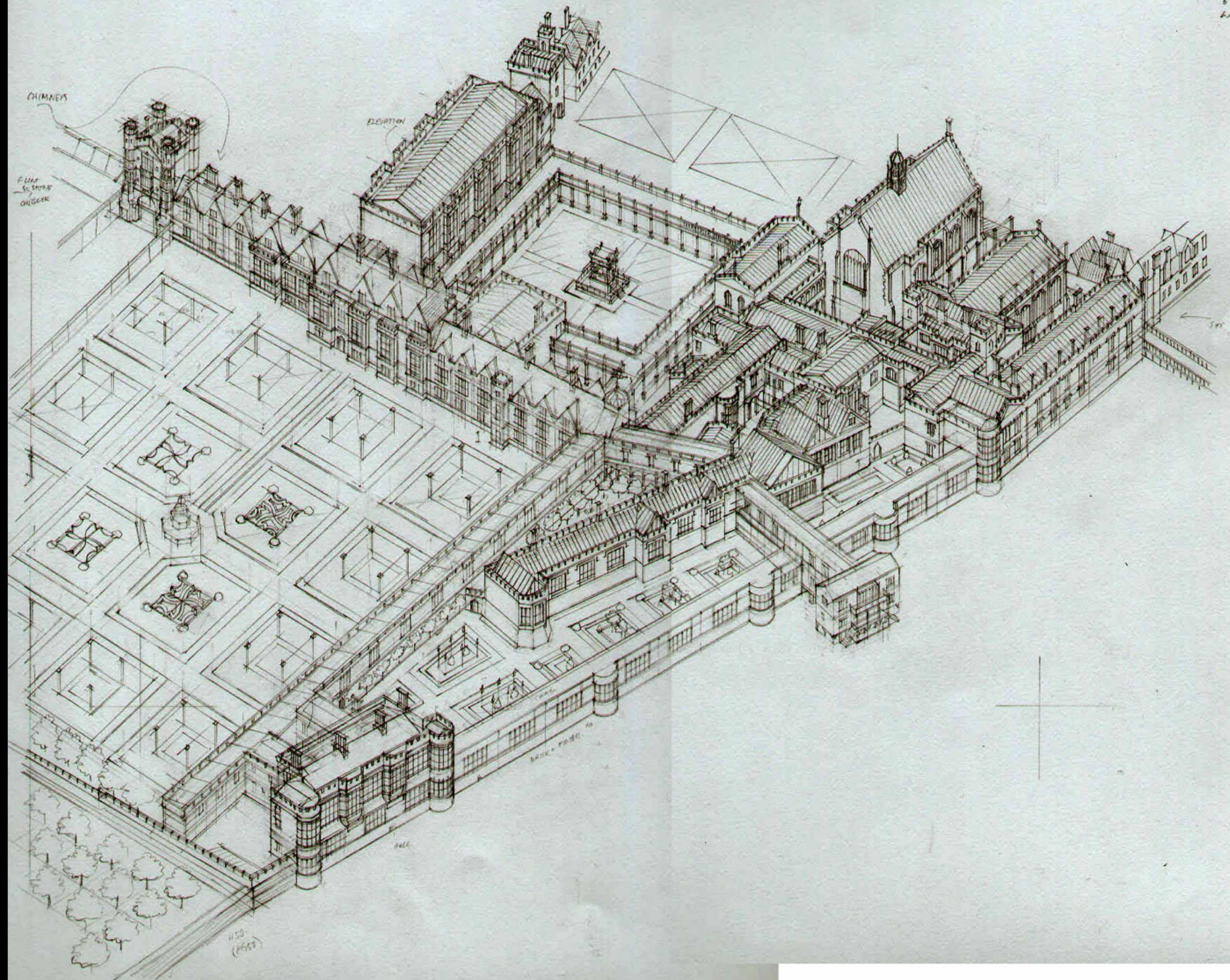

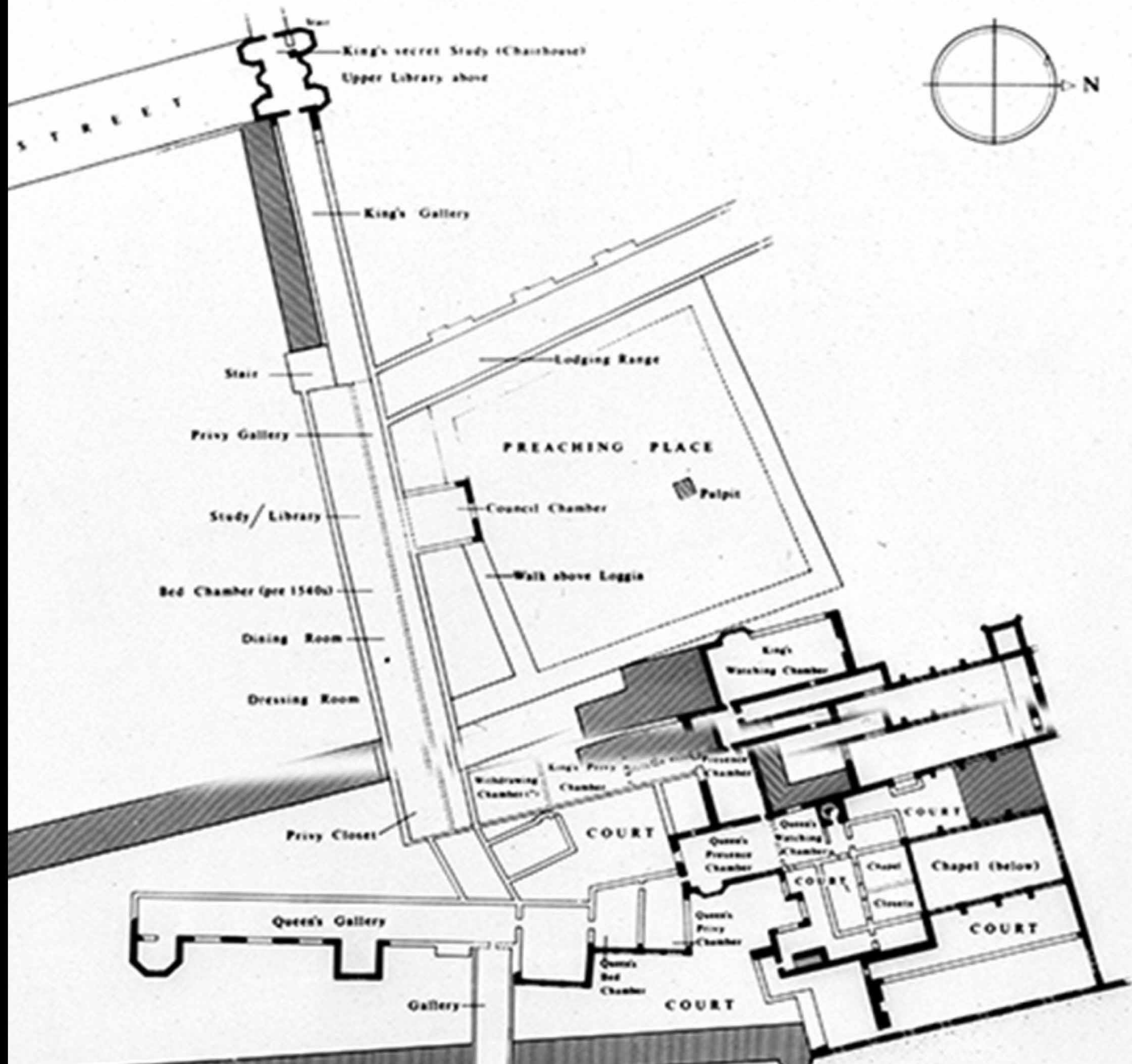

King's secret Study (Chairhouse)
Upper Library above

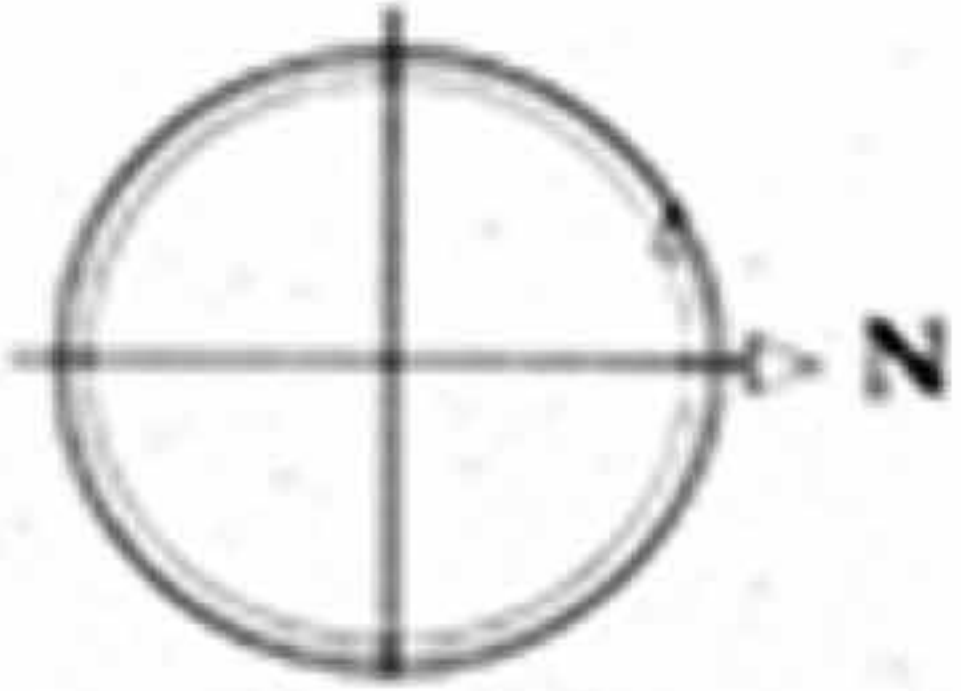

STREET

King's Gallery

Stair

Lodging Range

Privy Gallery

PREACHING PLACE

Pulpit

Study/Library

Council Chamber

Bed Chamber (pre 1540s)

Walk above Loggia

Dining Room

Dressing Room

King's Washing Chamber

Withdrawing Chamber's

King's Privy Chamber

Queen's Presence Chamber

COURT

Queen's Washing Chamber

Chapel

Chapel (below)

Privy Closet

Closets

COURT

Queen's Gallery

Queen's Privy Chamber

Gallery

Queen's Bed Chamber

COURT

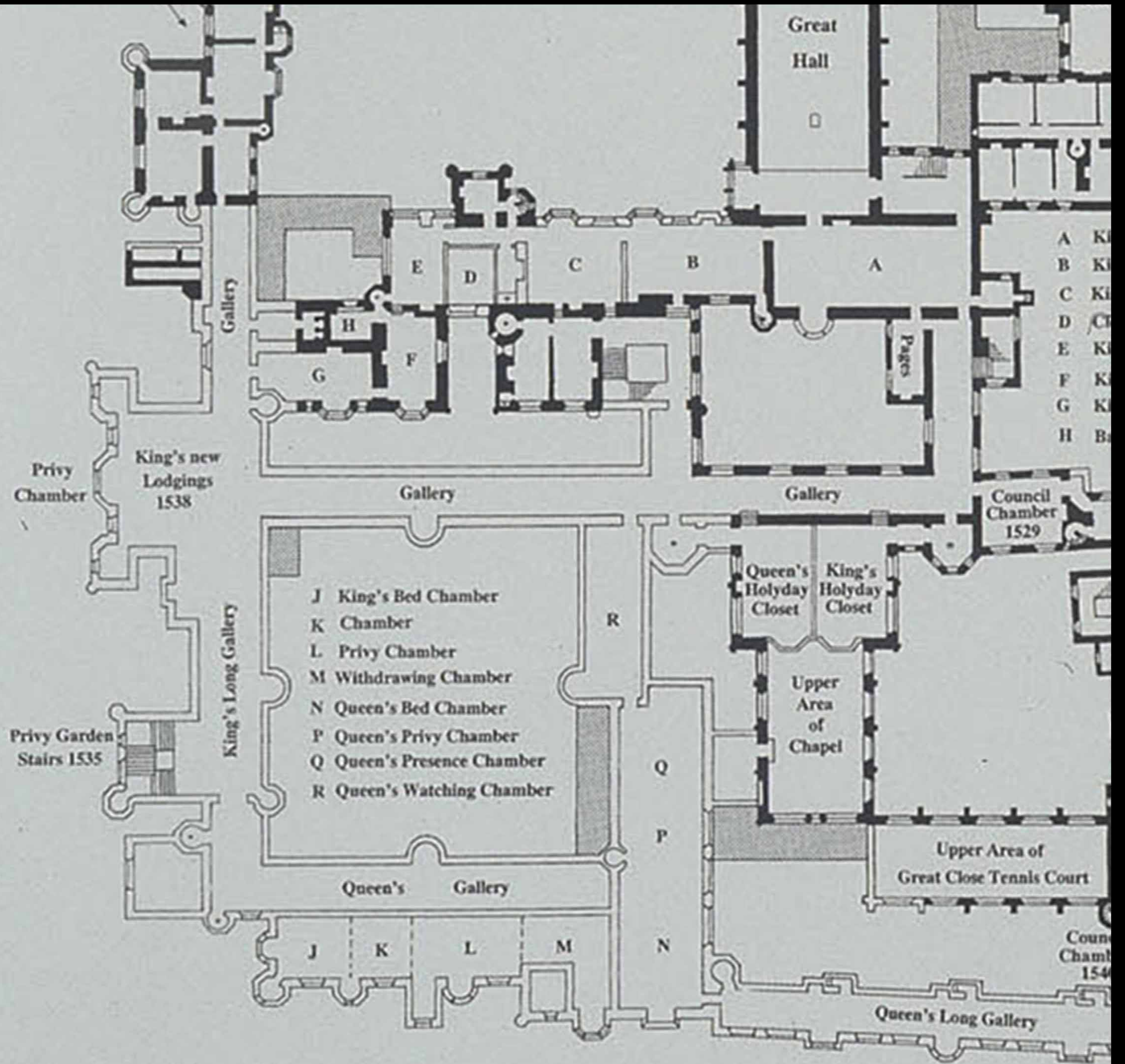

PLAN des Ruines de L'ancien Chateau de l'Ermine.
 Pour Faire Voir la Position des Deux Tours et Terrain Restant a Alléger

EXPLICATION

A. Tour sur la quelle est un vestige, un soubas de
 quel l'air se tire a plusieurs fois par jour
 B. Tour d'aparte de la tour A.
 C. Les Lignes ponctuées en rouge et noire C.
 indiquent le terrain de la ville et les demandés
 d'alignement avec les deux Tours A B

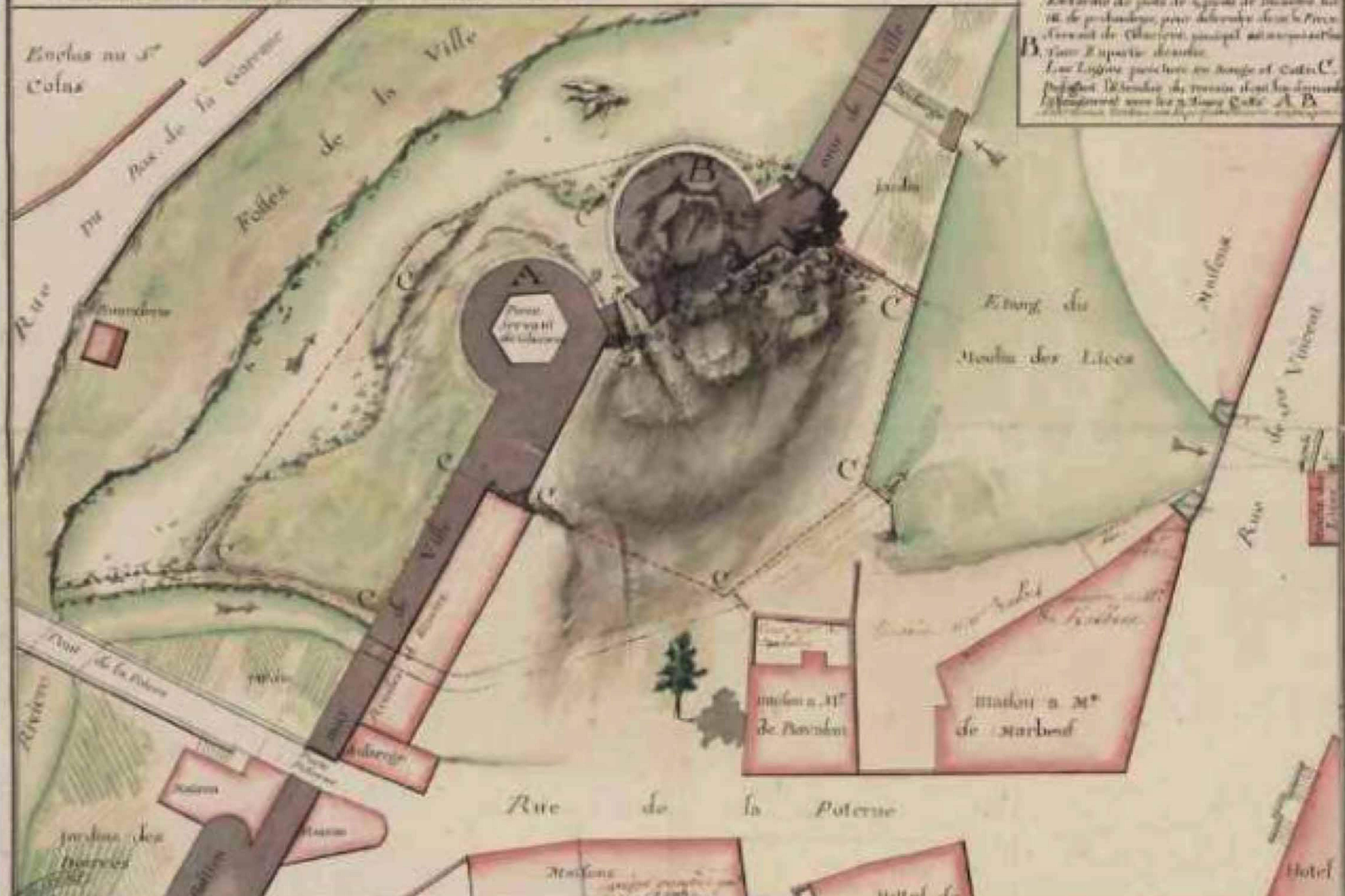

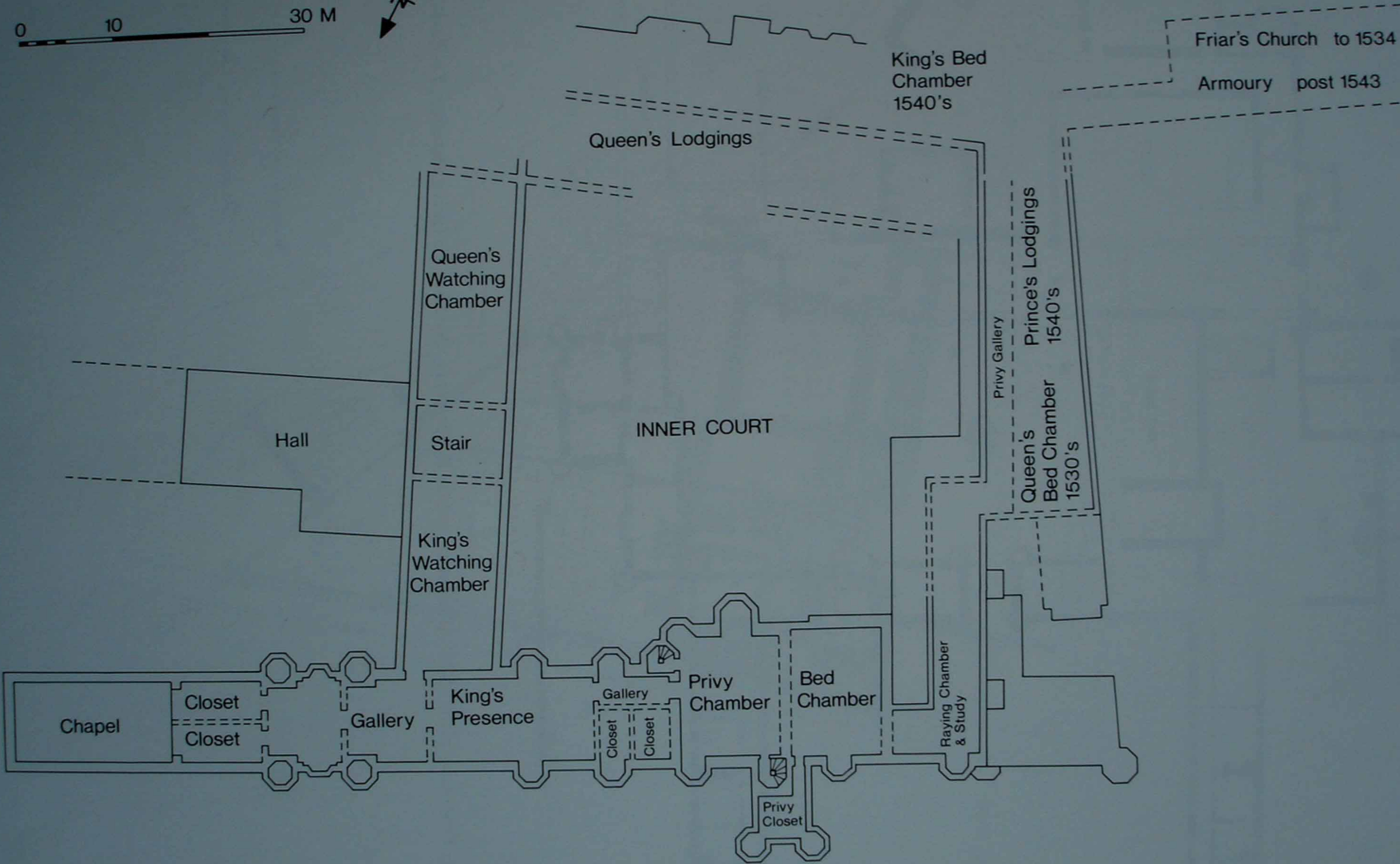
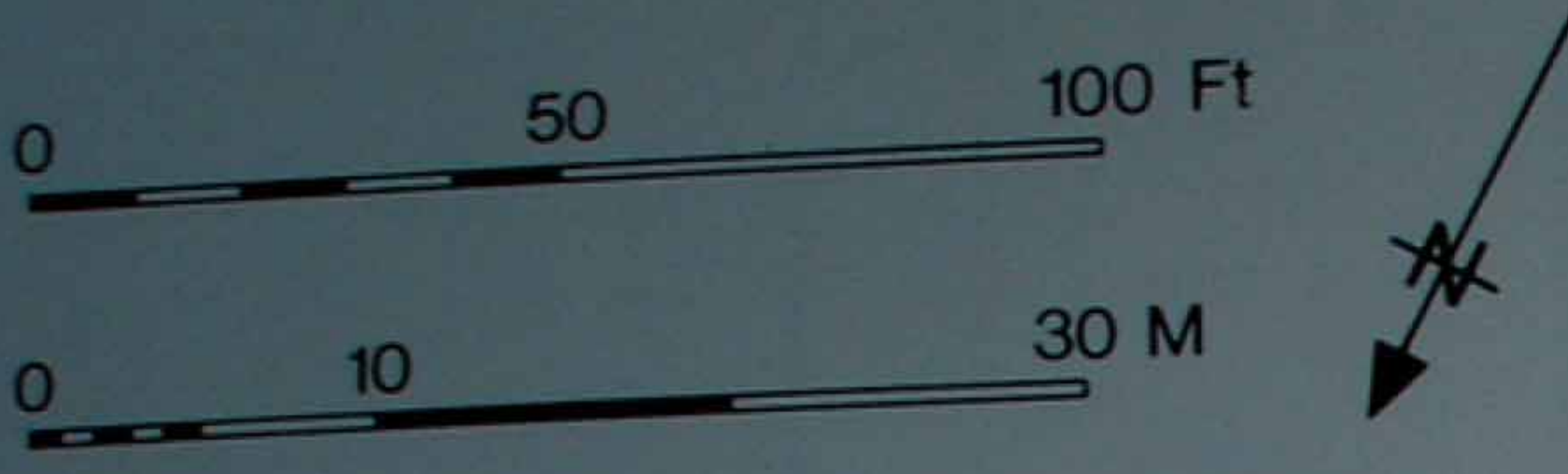

Plan 4. Ground floor, King's Palace, 1540-1550 (1715)









Anno 1505 20 octobris imago henrici VII. trancie regis illustissimi
ordinata p. henricum zwick. De regie ... uiliarium ...

ELIZABETHA
HENRICI

VXOR
VII

